



BOTEK-SCHEITZA GMBH

PRODUCT LIST

Drilling equipment for ECO-Rammhammer

Technical changes reserved.



Contents

Schappenköpfe / auger head	3
Cutting edge / gravel	5
Cutting edge / clay.....	7
Core catcher.....	9
Cutting shoe	9
Flap auger.....	11
Feather auger.....	19
Gravel auger with Hard tool DUR 600	20
Clay auger with Hard tool DUR 600.....	22
Gravel auger with Cutting edge	24
Clay auger with Cutting edge	26
Gravel pump	28
Inliner auger.....	29
Ramplate for casings.....	35
Cross- / flat- /moil-chisel	35
Pull bolt for casings	38
UP sampling device.....	39



Schappenköpfe / auger head

Schappenköpfe / auger head ø55; C45-drop forge



Description (D x d)					Article-Nr.
for casing	DN	120,0	x	55 mm	2002.1000.00
for casing	DN	127,0	x	55 mm	2002.0000.00
for casing	DN	133,0	x	55 mm	2002.0001.00
for casing	DN	139,7	x	55 mm	2002.0002.00
for casing	DN	146,0	x	55 mm	2002.0003.00
for casing	DN	152,4	x	55 mm	2002.0004.00
for casing	DN	159,0	x	55 mm	2002.0005.00
for casing	DN	168,3	x	55 mm	2002.0006.00
for casing	DN	171,0	x	55 mm	2002.0007.00
for casing	DN	177,8	x	55 mm	2002.0008.00
for casing	DN	193,7	x	55 mm	2002.0009.00
for casing	DN	203,0	x	55 mm	2002.0010.00
for casing	DN	219,1	x	55 mm	2002.0011.00
for casing	DN	241,0	x	55 mm	2002.0012.00
for casing	DN	244,5	x	55 mm	2002.0013.00
for casing	DN	254,0	x	55 mm	2002.0014.00
for casing	DN	267,0	x	55 mm	2002.0015.00
for casing	DN	273,0	x	55 mm	2002.0016.00
for casing	DN	298,5	x	55 mm	2002.0018.00
for casing	DN	305,0	x	55 mm	2002.0019.00
for casing	DN	323,9	x	55 mm	2002.0020.00



Schappenköpfe / auger head ø68; 42CrMo4-v

Description (D x d)					Article-Nr.
for casing	DN	120,0	x	68 mm	2002.1003.00
for casing	DN	127,0	x	68 mm	2002.0021.00
for casing	DN	133,0	x	68 mm	2002.0022.00
for casing	DN	139,7	x	68 mm	2002.0023.00
for casing	DN	146,0	x	68 mm	2002.0024.00
for casing	DN	152,4	x	68 mm	2002.0025.00
for casing	DN	159,0	x	68 mm	2002.0026.00
for casing	DN	168,3	x	68 mm	2002.0027.00
for casing	DN	171,0	x	68 mm	2002.0028.00
for casing	DN	177,8	x	68 mm	2002.0029.00
for casing	DN	193,7	x	68 mm	2002.0030.00
for casing	DN	203,0	x	68 mm	2002.0031.00
for casing	DN	219,1	x	68 mm	2002.0032.00
for casing	DN	241,0	x	68 mm	2002.0033.00
for casing	DN	244,5	x	68 mm	2002.0034.00
for casing	DN	254,0	x	68 mm	2002.0035.00
for casing	DN	267,0	x	68 mm	2002.0036.00
for casing	DN	273,0	x	68 mm	2002.0037.00
for casing	DN	298,5	x	68 mm	2002.0039.00
for casing	DN	305,0	x	68 mm	2002.0040.00
for casing	DN	323,9	x	68 mm	2002.0041.00

Other dimensions or other material on request!



Cutting edge for gravel

Cutting edge for gravel schappe / auger, nitration



Description (AD x WD x Length)					Article-Nr.
121,0	x	8,0	x	50 mm	2004.0000.00
121,0	x	10,0	x	50 mm	2004.0000.01
121,0	x	12,5	x	50 mm	2004.0000.02
127,0	x	8,0	x	50 mm	2004.0001.00
127,0	x	10,0	x	50 mm	2004.0001.01
127,0	x	12,5	x	50 mm	2004.0001.02
133,0	x	8,0	x	50 mm	2004.0002.00
133,0	x	10,0	x	50 mm	2004.0002.01
133,0	x	12,5	x	50 mm	2004.0002.02
139,7	x	8,0	x	50 mm	2004.0003.00
139,7	x	10,0	x	50 mm	2004.0003.01
139,7	x	12,5	x	50 mm	2004.0003.02
146,0	x	8,0	x	50 mm	2004.0004.00
146,0	x	10,0	x	50 mm	2004.0004.01
146,0	x	12,5	x	50 mm	2004.0004.02
152,4	x	8,0	x	50 mm	2004.0005.00
152,4	x	10,0	x	50 mm	2004.0005.01
152,4	x	12,5	x	50 mm	2004.0005.02
159,0	x	8,0	x	50 mm	2004.0006.00
159,0	x	10,0	x	50 mm	2004.0006.01
159,0	x	12,5	x	50 mm	2004.0006.02

**Description
(AD x WD x Length)**

Article-Nr.

168,3	x	8,0	x	50 mm	2004.0007.00
168,3	x	10,0	x	50 mm	2004.0007.01
168,3	x	12,8	x	50 mm	2004.0007.02
171,0	x	8,0	x	50 mm	2004.0008.00
171,0	x	10,0	x	50 mm	2004.0008.01
171,0	x	12,5	x	50 mm	2004.0008.02
177,8	x	8,0	x	50 mm	2004.0009.00
177,8	x	10,0	x	50 mm	2004.0009.01
177,8	x	12,5	x	50 mm	2004.0009.02
193,7	x	8,0	x	50 mm	2004.0010.00
193,7	x	10,0	x	50 mm	2004.0010.01
193,7	x	12,5	x	50 mm	2004.0010.02
203,0	x	8,0	x	50 mm	2004.0011.00
203,0	x	10,0	x	50 mm	2004.0011.01
203,0	x	12,5	x	50 mm	2004.0011.02
219,1	x	8,0	x	50 mm	2004.0012.00
219,1	x	10,0	x	50 mm	2004.0012.01
219,1	x	12,5	x	50 mm	2004.0012.02
241,0	x	8,0	x	50 mm	2004.0013.00
241,0	x	10,0	x	50 mm	2004.0013.01
241,0	x	12,5	x	50 mm	2004.0013.02
244,5	x	8,0	x	50 mm	2004.0014.00
244,5	x	10,0	x	50 mm	2004.0014.01
244,5	x	12,5	x	50 mm	2004.0014.02
254,0	x	8,0	x	50 mm	2004.0015.00
254,0	x	10,0	x	50 mm	2004.0015.01
254,0	x	12,5	x	50 mm	2004.0015.02
267,0	x	8,0	x	50 mm	2004.0016.00
267,0	x	10,0	x	50 mm	2004.0016.01
267,0	x	12,5	x	50 mm	2004.0016.02
273,0	x	8,0	x	50 mm	2004.0017.00
273,0	x	10,0	x	50 mm	2004.0017.01
273,0	x	12,5	x	50 mm	2004.0017.02
279,0	x	8,0	x	50 mm	2004.0018.00
279,0	x	10,0	x	50 mm	2004.0018.01
279,0	x	12,5	x	50 mm	2004.0018.02
298,5	x	8,0	x	50 mm	2004.0019.00
298,5	x	10,0	x	50 mm	2004.0019.01
298,5	x	12,5	x	50 mm	2004.0019.02
305,0	x	8,0	x	50 mm	2004.0020.00
305,0	x	10,0	x	50 mm	2004.0020.01
305,0	x	12,5	x	50 mm	2004.0020.02
323,9	x	8,0	x	50 mm	2004.0021.00
323,9	x	10,0	x	50 mm	2004.0021.01
323,9	x	12,5	x	50 mm	2004.0021.02



Cutting edge for clay

Cutting edge for clay auger, nitration



Description (AD x WD x Length)					Article-Nr.
121,0	x	7,1	x	50 mm	2004.0022.00
121,0	x	8,0	x	50 mm	2004.0022.01
127,0	x	7,1	x	50 mm	2004.0023.00
127,0	x	8,0	x	50 mm	2004.0023.01
133,0	x	7,1	x	50 mm	2004.0024.00
133,0	x	8,0	x	50 mm	2004.0024.01
139,7	x	7,1	x	50 mm	2004.0025.00
139,7	x	8,0	x	50 mm	2004.0025.01
146,0	x	7,1	x	50 mm	2004.0026.00
146,0	x	8,0	x	50 mm	2004.0026.01
152,4	x	7,1	x	50 mm	2004.0027.00
152,4	x	8,0	x	50 mm	2004.0027.01
159,0	x	7,1	x	50 mm	2004.0028.00
159,0	x	8,0	x	50 mm	2004.0028.01
168,3	x	7,1	x	50 mm	2004.0029.00
168,3	x	8,0	x	50 mm	2004.0029.01
171,0	x	7,1	x	50 mm	2004.0030.00
171,0	x	8,0	x	50 mm	2004.0030.01
177,8	x	7,1	x	50 mm	2004.0031.00
177,8	x	8,0	x	50 mm	2004.0031.01
193,7	x	7,1	x	50 mm	2004.0032.00
193,7	x	8,0	x	50 mm	2004.0032.01
203,0	x	7,1	x	50 mm	2004.0033.00
203,0	x	8,0	x	50 mm	2004.0033.01

Cutting edge for clay schappe / auger, nitration

Description (AD x WD x Length)					Article-Nr.
219,1	x	8,0	x	50 mm	2004.0034.00
241,0	x	8,0	x	50 mm	2004.0035.00
244,5	x	8,0	x	50 mm	2004.0036.00
254,0	x	8,0	x	50 mm	2004.0037.00
267,0	x	8,0	x	50 mm	2004.0038.00
273,0	x	8,0	x	50 mm	2004.0039.00
279,0	x	8,0	x	50 mm	2004.0040.00
298,5	x	8,0	x	50 mm	2004.0041.00
305,0	x	8,0	x	50 mm	2004.0042.00
323,9	x	8,0	x	50 mm	2004.0043.00

Core catcher



Core catcher complete for feather schappe / auger

Description	Article-Nr.
for auger diameter DN 133,0	2005.1000.00
for auger diameter DN 139,7	2005.1001.00
for auger diameter DN 177,8	2005.1002.00
for auger diameter DN 219,1	2005.1003.00
for auger diameter DN 273,0	2005.1004.00

Core catcher complete for inliner schappen / auger

Description	Article-Nr.
for auger diameter DN 133,0	2005.1005.00
for auger diameter DN 139,7	2005.1006.00
for auger diameter DN 177,8	2005.1007.00
for auger diameter DN 219,1	2005.1008.00
for auger diameter DN 273,0	2005.1009.00



Cutting shoe

Cutting shoe gravel for feather schappe / auger incl. core catcher



Description		Article-Nr.
for auger diameter	DN 133	2006.0000.00
for auger diameter	DN 140	2006.0001.00
for auger diameter	DN 178	2006.0002.00
for auger diameter	DN 219	2006.0003.00
for auger diameter	DN 273	2006.0004.00

Cutting shoe gravel for feather schappe / auger without core catcher



Description		Article-Nr.
for auger diameter	DN 133	2006.1000.00
for auger diameter	DN 140	2006.1001.00
for auger diameter	DN 178	2006.1002.00
for auger diameter	DN 219	2006.1003.00
for auger diameter	DN 273	2006.1004.00

Cutting clay for feather schappe / auger incl. core catcher



Description		Article-Nr.
for auger diameter	DN 133	2006.0005.00
for auger diameter	DN 140	2006.0006.00
for auger diameter	DN 178	2006.0007.00
for auger diameter	DN 219	2006.0008.00
for auger diameter	DN 273	2006.0009.00

Cutting clay for feather schappe / auger without core catcher



Description		Article-Nr.
for auger diameter	DN 133	2006.1005.00
for auger diameter	DN 140	2006.1006.00
for auger diameter	DN 178	2006.1007.00
for auger diameter	DN 219	2006.1008.00
for auger diameter	DN 273	2006.1009.00

Cutting shoe gravel for inliner schappen / auger incl. core catcher



Description		Article-Nr.
for auger diameter	DN 133	2006.0020.00
for auger diameter	DN 140	2006.0021.00
for auger diameter	DN 178	2006.0022.00
for auger diameter	DN 219	2006.0023.00
for auger diameter	DN 273	2006.0024.00

Cutting shoe gravel for inliner schappen / auger without core catcher



Description		Article-Nr.
for auger diameter	DN 133,0	2006.1020.00
for auger diameter	DN 139,7	2006.1021.00
for auger diameter	DN 177,8	2006.1022.00
for auger diameter	DN 219,1	2006.1023.00
for auger diameter	DN 273,0	2006.1024.00



Cutting clay for inliner schappen / auger incl. core catcher



Description		Article-Nr.
for auger diameter	DN 133	2006.0025.00
for auger diameter	DN 140	2006.0026.00
for auger diameter	DN 178	2006.0027.00
for auger diameter	DN 219	2006.0028.00
for auger diameter	DN 273	2006.0029.00

Cutting clay for inliner schappen / auger without core catcher



Description		Article-Nr.
for auger diameter	DN 133	2006.1025.00
for auger diameter	DN 140	2006.1026.00
for auger diameter	DN 178	2006.1027.00
for auger diameter	DN 219	2006.1028.00
for auger diameter	DN 273	2006.1029.00

Cutting shoe gravel for flap schappen / auger incl. steel flap



Description		Article-Nr.
for auger diameter	DN 133	2006.0010.00
for auger diameter	DN 140	2006.0011.00
for auger diameter	DN 178	2006.0012.00
for auger diameter	DN 219	2006.0013.00
for auger diameter	DN 273	2006.0014.00

Cutting shoe gravel for flap schappen / auger without steel flap



Description		Article-Nr.
for auger diameter	DN 133	2006.1010.00
for auger diameter	DN 140	2006.1011.00
for auger diameter	DN 178	2006.1012.00
for auger diameter	DN 219	2006.1013.00
for auger diameter	DN 273	2006.1014.00



Cutting shoe clay for flap schappen / auger incl. steel flap



Description		Article-Nr.
for auger diameter	DN 133	2006.0015.00
for auger diameter	DN 140	2006.0016.00
for auger diameter	DN 178	2006.0017.00
for auger diameter	DN 219	2006.0018.00
for auger diameter	DN 273	2006.0019.00

Cutting shoe clay for flap schappen / auger without steel flap



Description		Article-Nr.
for auger diameter	DN 133	2006.1015.00
for auger diameter	DN 140	2006.1016.00
for auger diameter	DN 178	2006.1017.00
for auger diameter	DN 219	2006.1018.00
for auger diameter	DN 273	2006.1019.00

Cutting shoe gravel for inliner schappe / auger incl. steel flap



Description		Article-Nr.
for auger diameter	DN 133	2006.0030.00
for auger diameter	DN 140	2006.0031.00
for auger diameter	DN 178	2006.0032.00
for auger diameter	DN 219	2006.0033.00
for auger diameter	DN 273	2006.0034.00

Cutting shoe gravel for inliner schappe / auger without steel flap



Description		Article-Nr.
for auger diameter	DN 133	2006.1030.00
for auger diameter	DN 140	2006.1031.00
for auger diameter	DN 178	2006.1032.00
for auger diameter	DN 219	2006.1033.00
for auger diameter	DN 273	2006.1034.00



Cutting shoe clay for inliner schappen / auger incl. steel flap



Description		Article-Nr.
for auger diameter	DN 133	2006.0035.00
for auger diameter	DN 140	2006.0036.00
for auger diameter	DN 178	2006.0037.00
for auger diameter	DN 219	2006.0038.00
for auger diameter	DN 273	2006.0039.00

Cutting shoe clay for inliner schappe / auger without steel flap



Description		Article-Nr.
for auger diameter	DN 133	2006.1035.00
for auger diameter	DN 140	2006.1036.00
for auger diameter	DN 178	2006.1037.00
for auger diameter	DN 219	2006.1038.00
for auger diameter	DN 273	2006.1039.00

Flap schappen / auger

Flap schappe / auger with cutting shoe/gravel and steel flap



Description (AD x WD x usable length)					Article-Nr.
133,0	x	10,0	x	1300 mm	2012.0000.00
139,7	x	10,0	x	1300 mm	2012.0001.00
177,8	x	11,0	x	1300 mm	2012.0002.00
219,1	x	12,0	x	1300 mm	2012.0003.00
273,0	x	13,0	x	1300 mm	2012.0004.00

Flap schappe / auger with cutting shoe/clay and steel flap



Description (AD x WD x usable length)					Article-Nr.
133,0	x	10,0	x	1300 mm	2012.0005.00
139,7	x	10,0	x	1300 mm	2012.0006.00
177,8	x	11,0	x	1300 mm	2012.0007.00
219,1	x	12,0	x	1300 mm	2012.0008.00
273,0	x	13,0	x	1300 mm	2012.0009.00



**Flap schappe / auger with cutting shoe/gravel and steel flap,
Schappenköpfe / auger head / auger head screwed**



Description (AD x WD x usable length)					Article-Nr.
133,0	x	10,0	x	1300 mm	2012.0010.00
139,7	x	10,0	x	1300 mm	2012.0011.00
177,8	x	11,0	x	1300 mm	2012.0012.00
219,1	x	12,0	x	1300 mm	2012.0013.00
273,0	x	13,0	x	1300 mm	2012.0014.00

**Flap schappe / auger with cutting shoe/clay and steel flap,
Schappenköpfe / auger head / auger head screwed**



Description (AD x WD x usable length)					Article-Nr.
133,0	x	10,0	x	1300 mm	2012.0015.00
139,7	x	10,0	x	1300 mm	2012.0016.00
177,8	x	11,0	x	1300 mm	2012.0017.00
219,1	x	12,0	x	1300 mm	2012.0018.00
273,0	x	13,0	x	1300 mm	2012.0019.00

Feather schappen / auger

Feather schappe / auger with cutting shoe/gravel and core catcher



Description (AD x WD x usable length)					Article-Nr.
133,0	x	10,0	x	1300 mm	2013.0000.00
139,7	x	10,0	x	1300 mm	2013.0001.00
177,8	x	11,0	x	1300 mm	2013.0002.00
219,1	x	12,0	x	1300 mm	2013.0003.00
273,0	x	13,0	x	1300 mm	2013.0004.00

Feather schappe / auger with cutting shoe/clay and core catcher



Description (AD x WD x usable length)					Article-Nr.
133,0	x	10,0	x	1300 mm	2013.0005.00
139,7	x	10,0	x	1300 mm	2013.0006.00
177,8	x	11,0	x	1300 mm	2013.0007.00
219,1	x	12,0	x	1300 mm	2013.0008.00
273,0	x	13,0	x	1300 mm	2013.0009.00



Feather schappe / auger with cutting shoe/gravel and steel flap, Schappenköpfe / auger head / auger head screwed



Description (AD x WD x usable length)					Article-Nr.
133,0	x	10,0	x	1300 mm	2013.0010.00
139,7	x	10,0	x	1300 mm	2013.0011.00
177,8	x	11,0	x	1300 mm	2013.0012.00
219,1	x	12,0	x	1300 mm	2013.0013.00
273,0	x	13,0	x	1300 mm	2013.0014.00

Feather schappe / auger with cutting shoe/clay and Steel flap, Schappenköpfe / auger head / auger head screwed



Description (AD x WD x usable length)					Article-Nr.
133,0	x	10,0	x	1300 mm	2013.0015.00
139,7	x	10,0	x	1300 mm	2013.0016.00
177,8	x	11,0	x	1300 mm	2013.0017.00
219,1	x	12,0	x	1300 mm	2013.0018.00
273,0	x	13,0	x	1300 mm	2013.0019.00

Gravel schappen / auger with hard tool DUR 600



Description (AD x WD x usable length)					Article-Nr.
121,0	x	8,0	x	1300 mm	2007.0000.00
121,0	x	10,0	x	1300 mm	2007.0000.01
121,0	x	12,5	x	1300 mm	2007.0000.02
127,0	x	8,0	x	1300 mm	2007.0001.00
127,0	x	10,0	x	1300 mm	2007.0001.01
127,0	x	12,5	x	1300 mm	2007.0001.02
133,0	x	8,0	x	1300 mm	2007.0002.00
133,0	x	10,0	x	1300 mm	2007.0002.01
133,0	x	12,5	x	1300 mm	2007.0002.02
139,7	x	8,0	x	1300 mm	2007.0003.00
139,7	x	10,0	x	1300 mm	2007.0003.01
139,7	x	12,5	x	1300 mm	2007.0003.02
146,0	x	8,0	x	1300 mm	2007.0004.00
146,0	x	10,0	x	1300 mm	2007.0004.01
146,0	x	12,5	x	1300 mm	2007.0004.02
152,4	x	8,0	x	1300 mm	2007.0005.00
152,4	x	10,0	x	1300 mm	2007.0005.01
152,4	x	12,5	x	1300 mm	2007.0005.02
159,0	x	8,0	x	1300 mm	2007.0006.00
159,0	x	10,0	x	1300 mm	2007.0006.01
159,0	x	12,5	x	1300 mm	2007.0006.02
168,3	x	8,0	x	1300 mm	2007.0007.00
168,3	x	10,0	x	1300 mm	2007.0007.01
168,3	x	12,5	x	1300 mm	2007.0007.02
171,0	x	8,0	x	1300 mm	2007.0008.00
171,0	x	10,0	x	1300 mm	2007.0008.01
171,0	x	12,5	x	1300 mm	2007.0008.02



Description (AD x WD x usable length)					Article-Nr.
177,8	x	8,0	x	1300 mm	2007.0009.00
177,8	x	10,0	x	1300 mm	2007.0009.01
177,8	x	12,5	x	1300 mm	2007.0009.02
193,7	x	8,0	x	1300 mm	2007.0010.00
193,7	x	10,0	x	1300 mm	2007.0010.01
193,7	x	12,5	x	1300 mm	2007.0010.01
203,0	x	8,0	x	1300 mm	2007.0011.00
203,0	x	10,0	x	1300 mm	2007.0011.01
203,0	x	12,5	x	1300 mm	2007.0011.02
219,1	x	8,0	x	1300 mm	2007.0012.00
219,1	x	10,0	x	1300 mm	2007.0012.01
219,1	x	12,5	x	1300 mm	2007.0012.02
241,0	x	8,0	x	1300 mm	2007.0013.00
241,0	x	10,0	x	1300 mm	2007.0013.01
241,0	x	12,5	x	1300 mm	2007.0013.02
244,5	x	8,0	x	1300 mm	2007.0014.00
244,5	x	10,0	x	1300 mm	2007.0014.01
244,5	x	12,5	x	1300 mm	2007.0014.02
254,0	x	8,0	x	1300 mm	2007.0015.00
254,0	x	10,0	x	1300 mm	2007.0015.01
254,0	x	12,5	x	1300 mm	2007.0015.02
267,0	x	8,0	x	1300 mm	2007.0016.00
267,0	x	10,0	x	1300 mm	2007.0016.01
267,0	x	12,5	x	1300 mm	2007.0016.02
273,0	x	8,0	x	1300 mm	2007.0017.00
273,0	x	10,0	x	1300 mm	2007.0017.01
273,0	x	12,5	x	1300 mm	2007.0017.02
279,0	x	8,0	x	1300 mm	2007.0018.00
279,0	x	10,0	x	1300 mm	2007.0018.01
279,0	x	12,5	x	1300 mm	2007.0018.02
298,5	x	8,0	x	1300 mm	2007.0019.00
298,5	x	10,0	x	1300 mm	2007.0019.01
298,5	x	12,5	x	1300 mm	2007.0019.02
305,0	x	8,0	x	1300 mm	2007.0020.00
305,0	x	10,0	x	1300 mm	2007.0020.01
305,0	x	12,5	x	1300 mm	2007.0020.02
323,9	x	8,0	x	1300 mm	2007.0021.00
323,9	x	10,0	x	1300 mm	2007.0021.01
323,9	x	12,5	x	1300 mm	2007.0021.02



Clay schappen / auger with hard tool DUR 600



Description (AD x WD x usable length)					Article-Nr.
121,0	x	7,1	x	1300 mm	2008.0000.00
121,0	x	8,0	x	1300 mm	2008.0000.01
127,0	x	7,1	x	1300 mm	2008.0001.00
127,0	x	8,0	x	1300 mm	2008.0001.01
133,0	x	7,1	x	1300 mm	2008.0002.00
133,0	x	8,0	x	1300 mm	2008.0002.01
139,7	x	7,1	x	1300 mm	2008.0003.00
139,7	x	8,0	x	1300 mm	2008.0003.01
146,0	x	7,1	x	1300 mm	2008.0004.00
146,0	x	8,0	x	1300 mm	2008.0004.01
152,4	x	7,1	x	1300 mm	2008.0005.00
152,4	x	8,0	x	1300 mm	2008.0005.01
159,0	x	7,1	x	1300 mm	2008.0006.00
159,0	x	8,0	x	1300 mm	2008.0006.01
168,3	x	7,1	x	1300 mm	2008.0007.00
168,3	x	8,0	x	1300 mm	2008.0007.01
171,0	x	7,1	x	1300 mm	2008.0008.00
171,0	x	8,0	x	1300 mm	2008.0008.01
177,8	x	7,1	x	1300 mm	2008.0009.00
177,8	x	8,0	x	1300 mm	2008.0009.01
193,7	x	7,1	x	1300 mm	2008.0010.00
193,7	x	8,0	x	1300 mm	2008.0010.01
203,0	x	7,1	x	1300 mm	2008.0011.00
203,0	x	8,0	x	1300 mm	2008.0011.01
219,1	x	7,1	x	1300 mm	2008.0012.00
219,1	x	8,0	x	1300 mm	2008.0012.01



Description (AD x WD x usable length)					Article-Nr.
241,0	x	7,1	x	1300 mm	2008.0013.00
241,0	x	8,0	x	1300 mm	2008.0013.01
244,5	x	7,1	x	1300 mm	2008.0014.00
244,5	x	8,0	x	1300 mm	2008.0014.01
254,0	x	7,1	x	1300 mm	2008.0015.00
254,0	x	8,0	x	1300 mm	2008.0015.01
267,0	x	7,1	x	1300 mm	2008.0016.00
267,0	x	8,0	x	1300 mm	2008.0016.01
273,0	x	7,1	x	1300 mm	2008.0017.00
273,0	x	8,0	x	1300 mm	2008.0017.01
279,0	x	7,1	x	1300 mm	2008.0018.00
279,0	x	8,0	x	1300 mm	2008.0018.01
298,5	x	7,1	x	1300 mm	2008.0019.00
298,5	x	8,0	x	1300 mm	2007.0019.01
305,0	x	7,1	x	1300 mm	2008.0020.00
305,0	x	8,0	x	1300 mm	2008.0020.01
323,9	x	7,1	x	1300 mm	2008.0021.00
323,9	x	8,0	x	1300 mm	2008.0021.01

Gravel schappen / auger with cutting edge



Description (AD x WD x usable length)					Article-Nr.
121,0	x	8,0	x	1300 mm	2009.0000.00
121,0	x	10,0	x	1300 mm	2009.0000.01
121,0	x	12,5	x	1300 mm	2009.0000.02
127,0	x	8,0	x	1300 mm	2009.0001.00
127,0	x	10,0	x	1300 mm	2009.0001.01
127,0	x	12,5	x	1300 mm	2009.0001.02
133,0	x	8,0	x	1300 mm	2009.0002.00
133,0	x	10,0	x	1300 mm	2009.0002.01
133,0	x	12,5	x	1300 mm	2009.0002.02
139,7	x	8,0	x	1300 mm	2009.0003.00
139,7	x	10,0	x	1300 mm	2009.0003.01
139,7	x	12,5	x	1300 mm	2009.0003.02
146,0	x	8,0	x	1300 mm	2009.0004.00
146,0	x	10,0	x	1300 mm	2009.0004.01
146,0	x	12,5	x	1300 mm	2009.0004.02



Description (AD x WD x usable length)					Article-Nr.
152,4	x	8,0	x	1300 mm	2009.0005.00
152,4	x	10,0	x	1300 mm	2009.0005.01
152,4	x	12,5	x	1300 mm	2009.0005.02
159,0	x	8,0	x	1300 mm	2009.0006.00
159,0	x	10,0	x	1300 mm	2009.0006.01
159,0	x	12,5	x	1300 mm	2009.0006.02
168,3	x	8,0	x	1300 mm	2009.0007.00
168,3	x	10,0	x	1300 mm	2009.0007.01
168,3	x	12,5	x	1300 mm	2009.0007.02
171,0	x	8,0	x	1300 mm	2009.0008.00
171,0	x	10,0	x	1300 mm	2009.0008.01
171,0	x	12,5	x	1300 mm	2009.0008.02
177,8	x	8,0	x	1300 mm	2009.0009.00
177,8	x	10,0	x	1300 mm	2009.0009.01
177,8	x	12,5	x	1300 mm	2009.0009.02
193,7	x	8,0	x	1300 mm	2009.0010.00
193,7	x	10,0	x	1300 mm	2009.0010.01
193,7	x	12,5	x	1300 mm	2009.0010.01
203,0	x	8,0	x	1300 mm	2009.0011.00
203,0	x	10,0	x	1300 mm	2009.0011.01
203,0	x	12,5	x	1300 mm	2009.0011.02
219,1	x	8,0	x	1300 mm	2009.0012.00
219,1	x	10,0	x	1300 mm	2009.0012.01
219,1	x	12,5	x	1300 mm	2009.0012.02
241,0	x	8,0	x	1300 mm	2009.0013.00
241,0	x	10,0	x	1300 mm	2009.0013.01
241,0	x	12,5	x	1300 mm	2009.0013.02
244,5	x	8,0	x	1300 mm	2009.0014.00
244,5	x	10,0	x	1300 mm	2009.0014.01
244,5	x	12,5	x	1300 mm	2009.0014.02
254,0	x	8,0	x	1300 mm	2009.0015.00
254,0	x	10,0	x	1300 mm	2009.0015.01
254,0	x	12,5	x	1300 mm	2009.0015.02
267,0	x	8,0	x	1300 mm	2009.0016.00
267,0	x	10,0	x	1300 mm	2009.0016.01
267,0	x	12,5	x	1300 mm	2009.0016.02
273,0	x	8,0	x	1300 mm	2009.0017.00
273,0	x	10,0	x	1300 mm	2009.0017.01
273,0	x	12,5	x	1300 mm	2009.0017.02
279,0	x	8,0	x	1300 mm	2009.0018.00
279,0	x	10,0	x	1300 mm	2009.0018.01
279,0	x	12,5	x	1300 mm	2009.0018.02
298,5	x	8,0	x	1300 mm	2009.0019.00
298,5	x	10,0	x	1300 mm	2009.0019.01
298,5	x	12,5	x	1300 mm	2009.0019.02
305,0	x	8,0	x	1300 mm	2009.0020.00
305,0	x	10,0	x	1300 mm	2009.0020.01



Description (AD x WD x usable length)					Article-Nr.
305,0	x	12,5	x	1300 mm	2009.0020.02
323,9	x	8,0	x	1300 mm	2009.0021.00
323,9	x	10,0	x	1300 mm	2009.0021.01
323,9	x	12,5	x	1300 mm	2009.0021.02

Clay schappen / auger with cutting edge



Description (AD x WD x usable length)					Article-Nr.
121,0	x	7,1	x	1300 mm	2010.0000.00
121,0	x	8,0	x	1300 mm	2010.0000.01
127,0	x	7,1	x	1300 mm	2010.0001.00
127,0	x	8,0	x	1300 mm	2010.0001.01
133,0	x	7,1	x	1300 mm	2010.0002.00
133,0	x	8,0	x	1300 mm	2010.0002.01
139,7	x	7,1	x	1300 mm	2010.0003.00
139,7	x	8,0	x	1300 mm	2010.0003.01
146,0	x	7,1	x	1300 mm	2010.0004.00
146,0	x	8,0	x	1300 mm	2010.0004.01
152,4	x	7,1	x	1300 mm	2010.0005.00
152,4	x	8,0	x	1300 mm	2010.0005.01
159,0	x	7,1	x	1300 mm	2010.0006.00
159,0	x	8,0	x	1300 mm	2010.0006.01
168,3	x	7,1	x	1300 mm	2010.0007.00
168,3	x	8,0	x	1300 mm	2010.0007.01
171,0	x	7,1	x	1300 mm	2010.0008.00
171,0	x	8,0	x	1300 mm	2010.0008.01
177,8	x	7,1	x	1300 mm	2010.0009.00
177,8	x	8,0	x	1300 mm	2010.0009.01
193,7	x	7,1	x	1300 mm	2010.0010.00
193,7	x	8,0	x	1300 mm	2010.0010.01
203,0	x	7,1	x	1300 mm	2010.0011.00
203,0	x	8,0	x	1300 mm	2010.0011.01
219,1	x	7,1	x	1300 mm	2010.0012.00
219,1	x	8,0	x	1300 mm	2010.0012.01
241,0	x	7,1	x	1300 mm	2010.0013.00
241,0	x	8,0	x	1300 mm	2010.0013.01



Description (AD x WD x usable length)					Article-Nr.
244,5	x	7,1	x	1300 mm	2010.0014.00
244,5	x	8,0	x	1300 mm	2010.0014.01
254,0	x	7,1	x	1300 mm	2010.0015.00
254,0	x	8,0	x	1300 mm	2010.0015.01
267,0	x	7,1	x	1300 mm	2010.0016.00
267,0	x	8,0	x	1300 mm	2010.0016.01
273,0	x	7,1	x	1300 mm	2010.0017.00
273,0	x	8,0	x	1300 mm	2010.0017.01
279,0	x	7,1	x	1300 mm	2010.0018.00
279,0	x	8,0	x	1300 mm	2010.0018.01
298,5	x	7,1	x	1300 mm	2010.0019.00
298,5	x	8,0	x	1300 mm	2010.0019.01
305,0	x	7,1	x	1300 mm	2010.0020.00
305,0	x	8,0	x	1300 mm	2010.0020.01
323,9	x	7,1	x	1300 mm	2010.0021.00
323,9	x	8,0	x	1300 mm	2010.0021.01

Gravel pump

Gravel pump with cutting shoe/rubber flap and ejection window



Description (AD x usable length)				Article-Nr.
139,7	x		1300 mm	2011.0004.00
177,8	x		1300 mm	2011.0005.00
219,1	x		1300 mm	2011.0006.00
273,0	x		1300 mm	2011.0007.00



Gravel pump with cutting shoe/steel flap and ejection window



Description (AD x Uusable length)				Article-Nr.
139,7	x		1300 mm	2011.0000.00
177,8	x		1300 mm	2011.0001.00
219,1	x		1300 mm	2011.0002.00
273,0	x		1300 mm	2011.0003.00

Inliner schappen / auger

Inliner schappe / auger with cutting shoe gravel and steel flap, lateral removal opening and PVC-inner tube



Description (AD x WD x usable length)					Article-Nr.
139,7	x	10,0	x	1300 mm	2014.0011.00
177,8	x	10,0	x	1300 mm	2014.0012.00
219,1	x	10,0	x	1300 mm	2014.0013.00
273,0	x	10,0	x	1300 mm	2014.0014.00

Inliner schappe / auger with cutting shoe clay and steel flap, lateral removal opening and PVC-inner tube



Description (AD x WD x usable length)					Article-Nr.
139,7	x	10,0	x	1300 mm	2014.0016.00
177,8	x	10,0	x	1300 mm	2014.0017.00
219,1	x	10,0	x	1300 mm	2014.0018.00
273,0	x	10,0	x	1300 mm	2014.0019.00



Inliner schappe / auger with cutting shoe gravel and gore catcher, lateral removal opening and PVC-inner tube



Description (AD x WD x usable length)					Article-Nr.
139,7	x	10,0	x	1300 mm	2014.0001.00
177,8	x	10,0	x	1300 mm	2014.0002.00
219,1	x	10,0	x	1300 mm	2014.0003.00
273,0	x	10,0	x	1300 mm	2014.0004.00

Inliner schappe / auger with cutting shoe clay and core catcher, lateral removal opening and PVC-inner tube



Description (AD x WD x usable length)					Article-Nr.
139,7	x	10,0	x	1300 mm	2014.0006.00
177,8	x	10,0	x	1300 mm	2014.0007.00
219,1	x	10,0	x	1300 mm	2014.0008.00
273,0	x	10,0	x	1300 mm	2014.0009.00

**Inliner schappe / auger with cutting shoe gravel and steel flap,
Schappenköpfe / auger head / auger head screwed and PVC-inner tube**



Description (AD x WD x usable length)					Article-Nr.
139,7	x	10,0	x	1300 mm	2014.0031.00
177,8	x	10,0	x	1300 mm	2014.0032.00
219,1	x	10,0	x	1300 mm	2014.0033.00
273,0	x	10,0	x	1300 mm	2014.0034.00



Inliner schappe / auger with cutting shoe clay and steel flap, Schappenköpfe / auger head / auger head screwed and PVC-inner tube



Description (AD x WD x usable length)					Article-Nr.
139,7	x	10,0	x	1300 mm	2014.0036.00
177,8	x	10,0	x	1300 mm	2014.0037.00
219,1	x	10,0	x	1300 mm	2014.0038.00
273,0	x	10,0	x	1300 mm	2014.0039.00

Inliner schappe / auger with cutting shoe gravel and core catcher, Schappenköpfe / auger head / auger head screwed and PVC-inner tube



Description (AD x WD x usable length)					Article-Nr.
139,7	x	10,0	x	1300 mm	2014.0021.00
177,8	x	10,0	x	1300 mm	2014.0022.00
219,1	x	10,0	x	1300 mm	2014.0023.00
273,0	x	10,0	x	1300 mm	2014.0024.00

Inliner schappe / auger with cutting shoe clay and core catcher, Schappenköpfe / auger head / auger head screwed and PVC-inner tube



Description (AD x WD x usable length)					Article-Nr.
139,7	x	10,0	x	1300 mm	2014.0026.00
177,8	x	10,0	x	1300 mm	2014.0027.00
219,1	x	10,0	x	1300 mm	2014.0028.00
273,0	x	10,0	x	1300 mm	2014.0029.00

Inliner schappe / auger with cutting shoe gravel and steel flap, Schappenköpfe / auger head / auger head welded and PVC-inner tube



Description (AD x WD x usable length)					Article-Nr.
139,7	x	10,0	x	1300 mm	2014.0051.00
177,8	x	10,0	x	1300 mm	2014.0052.00
219,1	x	10,0	x	1300 mm	2014.0053.00
273,0	x	10,0	x	1300 mm	2014.0054.00



Inliner schappe / auger with cutting shoe clay and steel flap, Schappenköpfe / auger head / auger head welded and PVC-inner tube



Description (AD x WD x usable length)					Article-Nr.
139,7	x	10,0	x	1300 mm	2014.0056.00
177,8	x	10,0	x	1300 mm	2014.0057.00
219,1	x	10,0	x	1300 mm	2014.0058.00
273,0	x	10,0	x	1300 mm	2014.0059.00

Inliner schappe / auger with cutting shoe gravel and core catcher, Schappenköpfe / auger head / auger head welded and PVC-inner tube



Description (AD x WD x usable length)					Article-Nr.
139,7	x	10,0	x	1300 mm	2014.0041.00
177,8	x	10,0	x	1300 mm	2014.0042.00
219,1	x	10,0	x	1300 mm	2014.0043.00
273,0	x	10,0	x	1300 mm	2014.0044.00

Inliner schappe / auger with cutting shoe clay and core catcher, Schappenköpfe / auger head / auger head welded and PVC-inner tube



Description (AD x WD x usable length)					Article-Nr.
139,7	x	10,0	x	1300 mm	2014.0046.00
177,8	x	10,0	x	1300 mm	2014.0047.00
219,1	x	10,0	x	1300 mm	2014.0048.00
273,0	x	10,0	x	1300 mm	2014.0049.00



Ramplates for casings

Ramplate with bolt welded for casings

Description		Article-Nr.
Ramplate with bolt welded for casings	DN 152,4	2015.0000.00
Ramplate with bolt welded for casings	DN 168,3	2015.0001.00
Ramplate with bolt welded for casings	DN 177,8	2015.0002.00
Ramplate with bolt welded for casings	DN 203,0	2015.0003.00
Ramplate with bolt welded for casings	DN 219,1	2015.0004.00
Ramplate with bolt welded for casings	DN 241,0	2015.0005.00
Ramplate with bolt welded for casings	DN 244,5	2015.0006.00
Ramplate with bolt welded for casings	DN 254,0	2015.0007.00
Ramplate with bolt welded for casings	DN 267,0	2015.0008.00
Ramplate with bolt welded for casings	DN 273,0	2015.0009.00
Ramplate with bolt welded for casings	DN 298,5	2015.0011.00
Ramplate with bolt welded for casings	DN 305,0	2015.0012.00
Ramplate with bolt welded for casings	DN 323,9	2015.0013.00
Ramplate with bolt welded for casings	DN 355,6	2015.0014.00
Ramplate with bolt welded for casings	DN 368,0	2015.0015.00
Ramplate with bolt welded for casings	DN 419,1	2015.0016.00

Ram bolt

Description		Article-Nr.
Ram bolt	DN 55	2015.1000.00
Ram bolt	DN 68	2015.1001.00

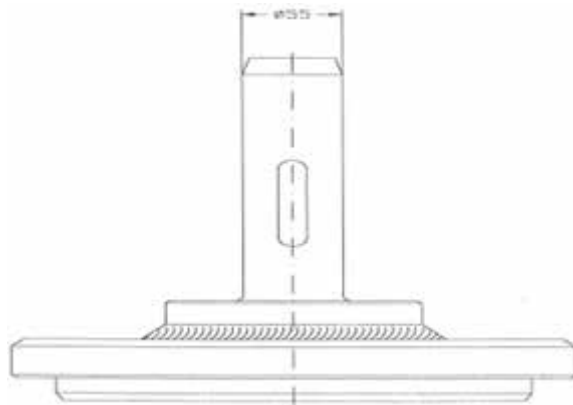

Cross-/flat-/moil-chisel

Cross chisel



Description		Article-Nr.
Cross chisel	DN 120 mm	2016.0000.00
Cross chisel	DN 140 mm	2016.0001.00
Cross chisel	DN 150 mm	2016.0002.00
Cross chisel	DN 160 mm	2016.0003.00
Cross chisel	DN 170 mm	2016.0004.00
Cross chisel	DN 180 mm	2016.0005.00



Flat chisel



Description		Article-Nr.
Flat chisel	DN 120 mm	2016.0006.00
Flat chisel	DN 140 mm	2016.0007.00
Flat chisel	DN 150 mm	2016.0008.00
Flat chisel	DN 160 mm	2016.0009.00
Flat chisel	DN 170 mm	2016.0010.00
Flat chisel	DN 180 mm	2016.0011.00

Moil chisel

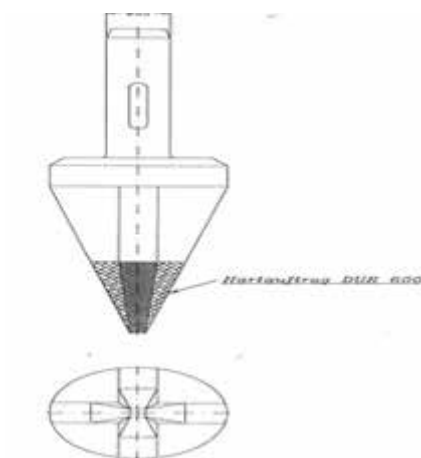

Description		Article-Nr.
Moil chisel	DN 120 mm	2016.0012.00
Moil chisel	DN 140 mm	2016.0013.00
Moil chisel	DN 150 mm	2016.0014.00
Moil chisel	DN 160 mm	2016.0015.00
Moil chisel	DN 170 mm	2016.0016.00
Moil chisel	DN 180 mm	2016.0017.00

Pull bolt for casings – Pull loop

Pull bolt for casings

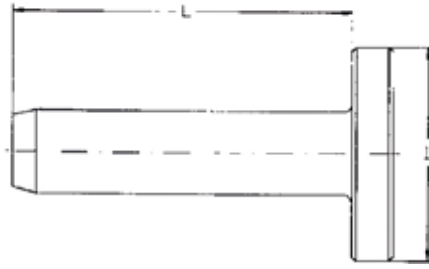

Description		Article-Nr.
Pull bolt for casings	DN 152,4	2017.1000.00
Pull bolt for casings	DN 168,3	2017.1001.00
Pull bolt for casings	DN 177,8	2017.1002.00
Pull bolt for casings	DN 203,0	2017.1003.00
Pull bolt for casings	DN 219,1	2017.1004.00
Pull bolt for casings	DN 241,0	2017.1005.00
Pull bolt for casings	DN 244,5	2017.1006.00
Pull bolt for casings	DN 254,0	2017.1007.00
Pull bolt for casings	DN 267,0	2017.1008.00
Pull bolt for casings	DN 273,0	2017.1009.00
Pull bolt for casings	DN 298,5	2017.1010.00
Pull bolt for casings	DN 305,0	2017.1011.00
Pull bolt for casings	DN 323,9	2017.1012.00
Pull bolt for casings	DN 355,6	2017.1013.00
Pull bolt for casings	DN 368,0	2017.1014.00
Pull bolt for casings	DN 419,1	2017.1015.00

Pull loop



Description		Article-Nr.
Pull loop	DN 55	2017.0000.00
Pull loop	DN 68	2017.0001.00



UP sampling device



Description	Article-Nr.
Standard	2018.0000.00
With vacuum pump	2018.0001.00

UP-hull

Description	Article-Nr.
UP-hull	DN 120x3
	2018.1000.00



BOTEC-SCHEITZA GMBH

Contact

Botec-Scheitza GmbH
Mr. Scheitza
Waldstraße 1
84149 Velden
GERMANY
Tel.: 0049 (0) 8742 9687-0
Mail: info@botec-scheitza.de

WWW.BOTEC-SCHEITZA.DE

Your local partner in CZ

Mr. Ing. Ivan Kraml
Pod Mustkem 808
252 19 Rudna
Czech Republic
Tel.: 0042 (0) 602 325929
Mail: ikraml@seznam.cz oder
Info@botec-scheitza.de

